

2000 I-30 E
Greenville, TX 75402

Tuesday, May 30, 2023

Office of Hopkins County Judge
PO Box 288
Sulphur Springs TX 75483

Farmers Electric Cooperative Member: John M Clark Jr
Service Order Number: 2023043820

Greetings:

Farmers Electric Cooperative, Inc. is requesting permission to construct electrical power distribution facilities which will cross County Road 3520 which is located in Hopkins County, Texas.

Site location map and construction sketches are enclosed. The construction sketch details the proposed work. All road crossings will have a minimum vertical clearance of 22 feet.

If you have any questions, please contact me at any time.

Sincerely,

Catherine Rollins
Project Coordinator
crollins@farmerselectric.coop
Phone 903-513-0259

Submitted by Kim Harry
kharry@farmerselectric.coop
Engineering Coordinator

Enclosures

County Approval Section:

Approved:

Denied:

Authorized Signature: *Wendi Boethy*

Date: 6-12-23

14.4KV

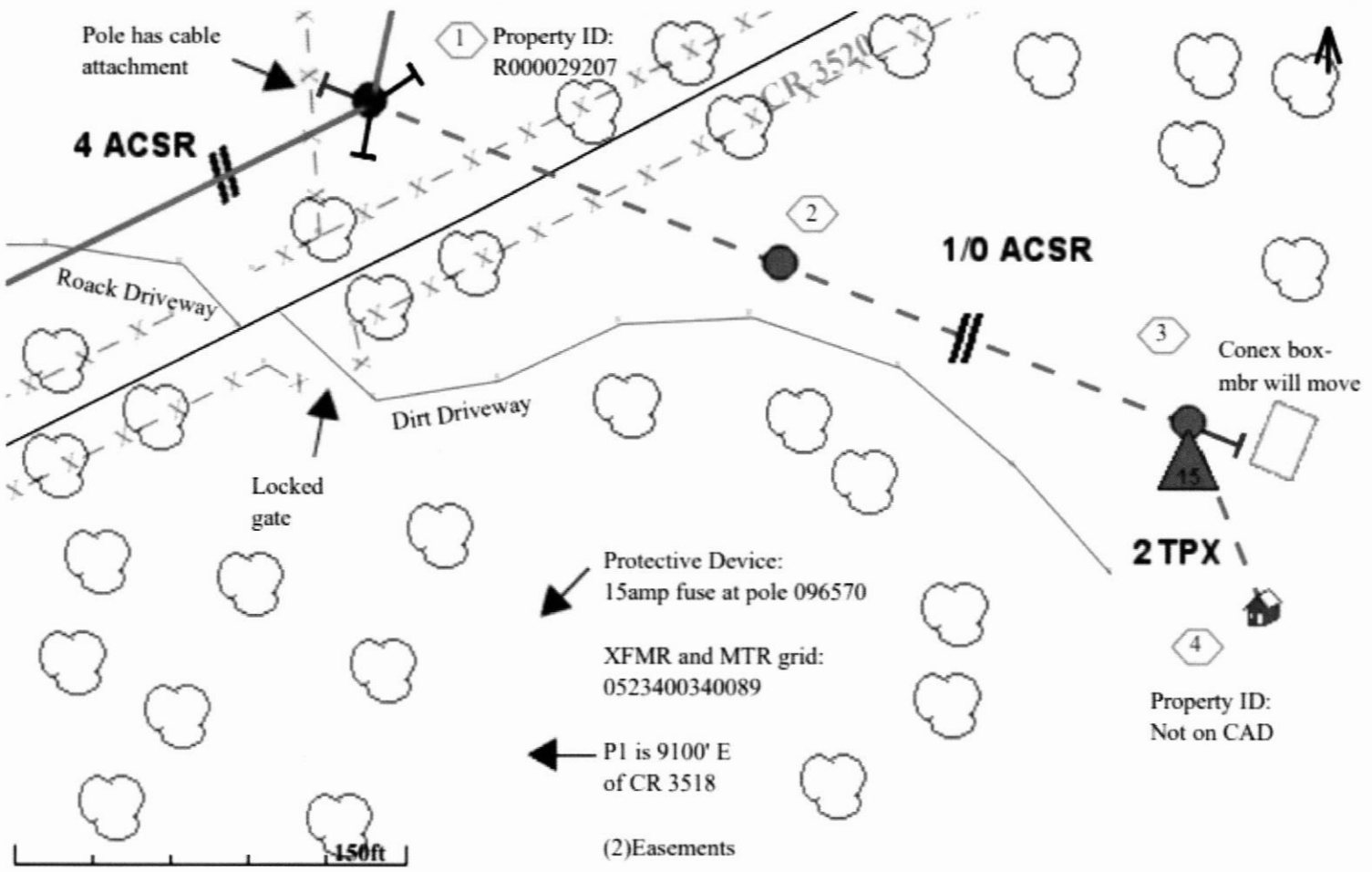

137176

County Road 3520

FR



2000 I-30 E
Greenville, TX 75402

Thursday, June 8, 2023

Office of Hopkins County Judge
PO Box 288
Sulphur Springs TX 75483

Farmers Electric Cooperative Member: SANDRA RILEY
Service Order Number: 2023013607

Greetings:

Farmers Electric Cooperative, Inc. is requesting permission to construct electrical power distribution facilities which will cross County Road 3506 which is located 150' SW of CR 3510 in Hopkins County, Texas.

Site location map and construction sketches are enclosed. The construction sketch details the proposed work. All road crossings will have a minimum vertical clearance of 22 feet.

If you have any questions, please contact me at any time.

Sincerely,

Catherine Rollins
Project Coordinator
Choose an item.@farmerselectric.coop
Phone 903-513-0259

Submitted by Shaya Smith
ssmith@farmerselectric.coop
Engineering Coordinator

Enclosures

County Approval Section:

Approved: Denied:

Authorized Signature: Wade Bentley Date: 6-12-23



2000 I-30 E
Greenville, TX 75402

FEC Cooperative Member: SANDRA RILEY

Service Order Number: 2023013607

electrical power will cross County Road 3506
which is located 150' SW of CR 3510 in Hopkins
County, Texas.

County Road 3510



County Road 3506

106250



2000 I-30 E
Greenville, TX 75402

Monday, June 5, 2023

Office of Hopkins County Judge
PO Box 288
Sulphur Springs TX 75483

Farmers Electric Cooperative Member: RICHARD BOSTON
Service Order Number: 2023035627

Greetings:

Farmers Electric Cooperative, Inc. is requesting permission to construct electrical power distribution facilities which will install a new pole inline in the county row on County Road 2426 which is located 1400' S OF CR 2422 in Hopkins County, Texas.2426

Site location map and construction sketches are enclosed. The construction sketch details the proposed work. Choose an item.

If you have any questions, please contact me at any time.

Sincerely,

Meagan Lee

Project Coordinator
meaganl@farmerselectric.coop
Phone 903-513-0378

Submitted by Psalm Harper
pharper@farmerselectric.coop
Engineering Coordinator

Enclosures

County Approval Section:

Approved: _____ Denied: _____

Authorized Signature: _____

Date: 6-12-23

↑
PROTECTIVE DEVICE:
OCR-082303

GRID: 0933040040050

↑
P1 IS 1400 FEET S
OF CR 2422

250ft

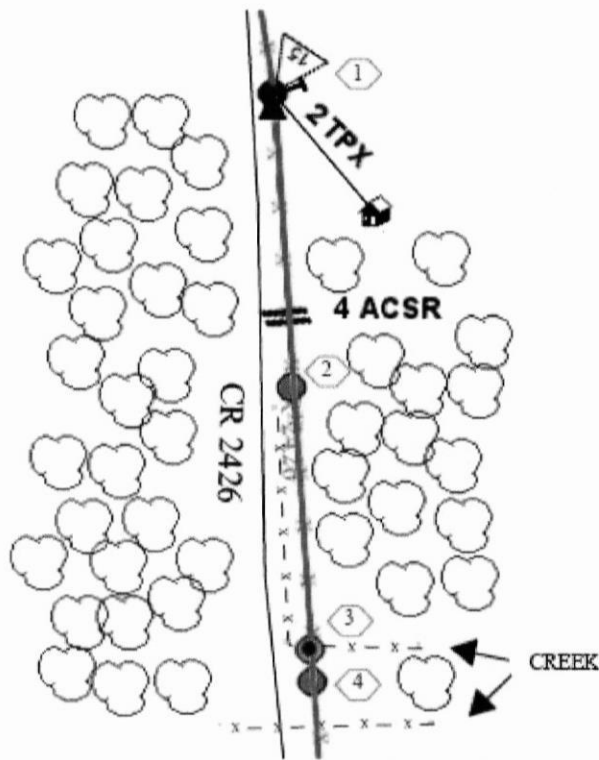

County Road 242

33040040050

75471

082491

33040040060

MARTIN ALLAIN
EAST SERVICE AREA



2000 I-30 E
Greenville, TX 75402

Wednesday, May 31, 2023

Office of Hopkins County Judge
PO Box 288
Sulphur Springs TX 75483

Farmers Electric Cooperative Member: **BRITTANY GENTRY**
Service Order Number: 2023026365

Greetings:

Farmers Electric Cooperative, Inc. is requesting permission to construct electrical power distribution facilities which will cross County Road 4582 which is located 2500' NW of FM 3236 in Hopkins County, Texas.

Site location map and construction sketches are enclosed. The construction sketch details the proposed work. All road crossings will have a minimum vertical clearance of 22 feet.

If you have any questions, please contact me at any time.

Sincerely,

Catherine Rollins
Project Coordinator
crollins@farmerselectric.coop
Phone 903-513-0259

Submitted by Shaya Smith
ssmith@farmerselectric.coop
Field Engineering Coordinator

Enclosures

County Approval Section:

Approved: Denied:

Authorized Signature: 

Date: 6-1-23



2000 I-30 E
Greenville, TX 75402

